

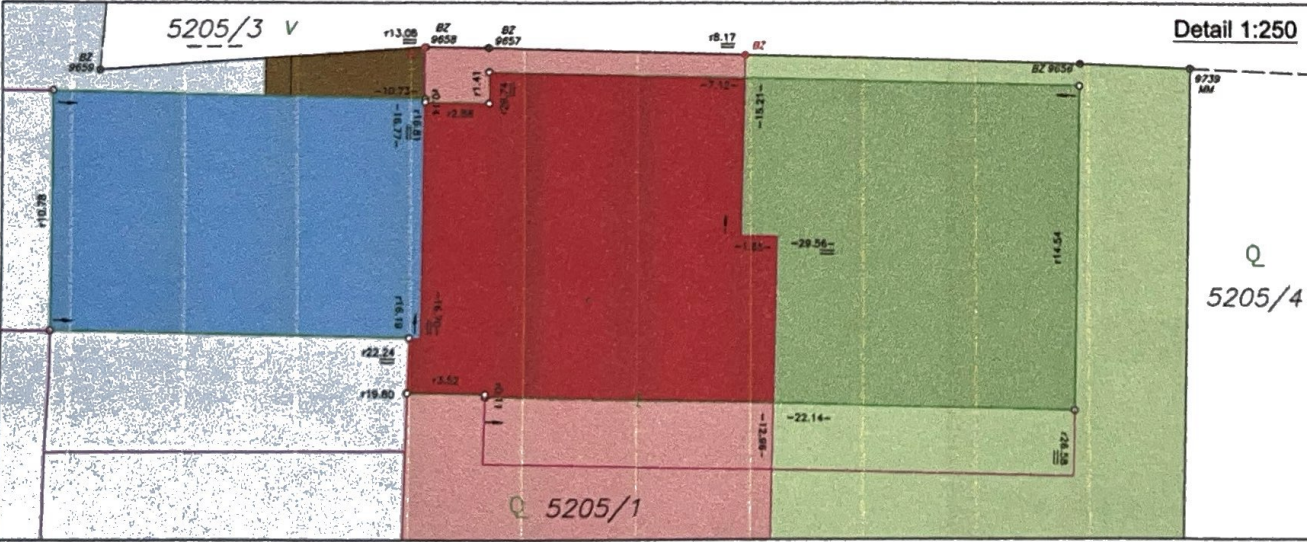

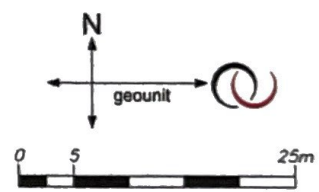

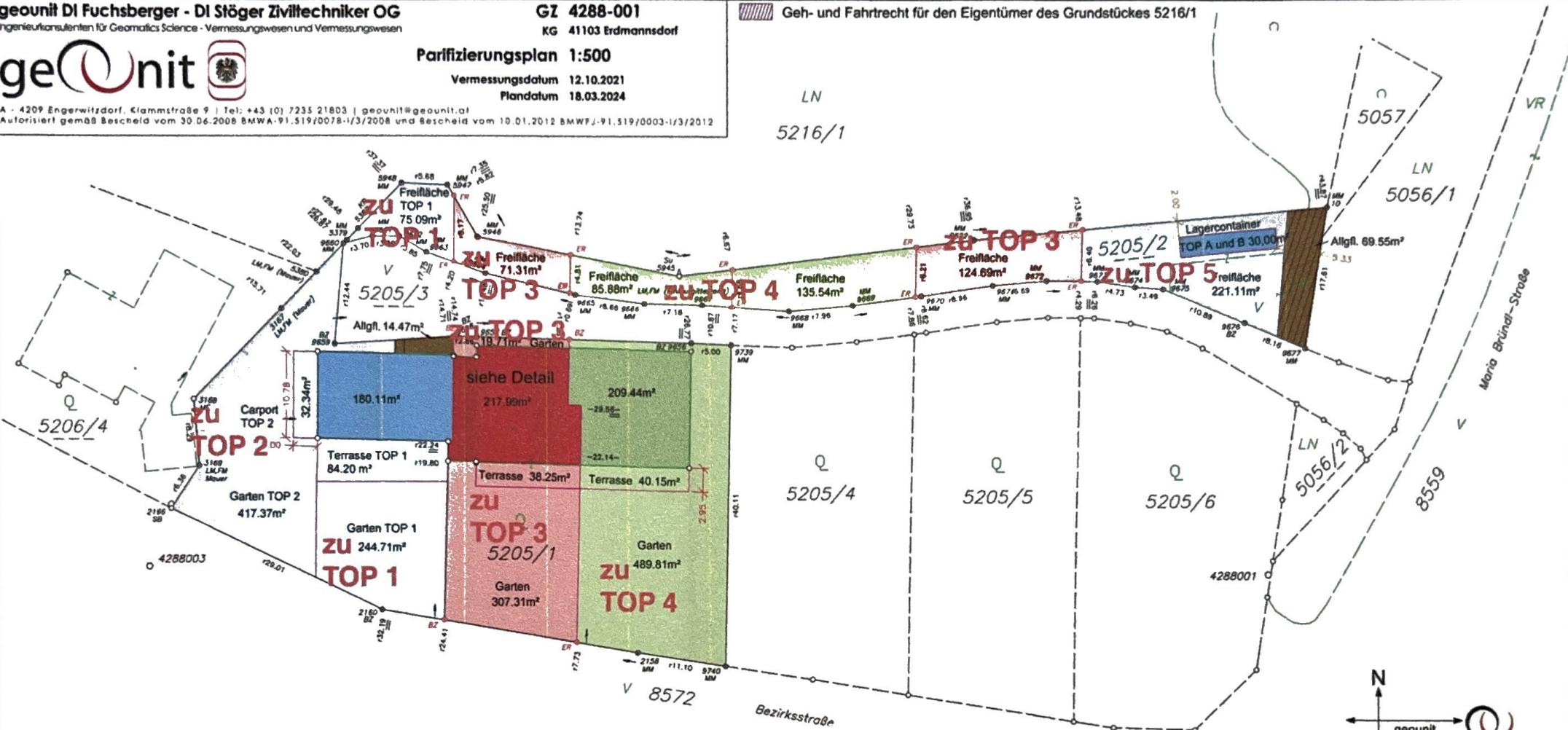





 Geh- und Fahrrecht für den Eigentümer des Grundstückes 5216/1



	TOP1	Harmonie A	TOP2	Harmonie B	Harmonie C
5205/1	 328.91 m ²	180.11 m ²	449.71 m ²	 217.99 m ²  19.71 m ²	 209.44 m ²  529.96 m ²
5205/2	 75.09 m ²	251.11 m ²		 71.31 m ²  124.69 m ²	 85.88 m ²  135.54 m ²
Gesamt:	404.00 m²	431.22 m²	449.71 m²	779.26 m²	960.82 m²

 Allgemeinfläche (Allgfl.) für Harmonie A, B und C 84.02 m²

- Legende:**
- BZ = Grenzpunktbolzen
 - BK = Bordsteinkante
 - ES = Eisenstange
 - FM = Farbmarke
 - HE = Hausecke
 - KR = Kreuz
 - LM = Lochmarke
 - ME = Mauerecke
 - KM = Kunststoffmarke
 - MM = Metallmarke
 - SB = Grenzstein behauen
 - SU = Grenzstein unbehauen
 - ZE = Zaunecke
 - ZS = Zaunsäule
 - ZSE = Zaunsockellecke